



DE Bedienungsanleitung

Bitte bewahren Sie die Bedienungsanleitung auf!

GB Operating instructions

Please keep these instructions in a safe place!

FR Instructions d'utilisation

Veillez conserver les présentes instructions d'utilisation !

Safety instructions GB- 2

Explanation of displays and buttons GB- 3

General information GB- 4

Designated use GB- 4

Installation/Connection GB- 5

Sample terminal diagrams GB- 6

Technical data GB- 7

Cleaning GB- 7

General declaration of conformity GB- 7



Warning!

Important safety instructions!

Always observe the following instructions.

- The provisions of the local public utilities and stipulations for wet and damp rooms in accordance with VDE 100 must be observed during system installation.
- For use in dry rooms only.
- Use unmodified **elero** original parts only.
- Keep persons away from the systems guide track.
- Keep children away from controls.
- Always comply with national stipulations.
- The equipment contains small parts that could be swallowed.

Explanation of buttons

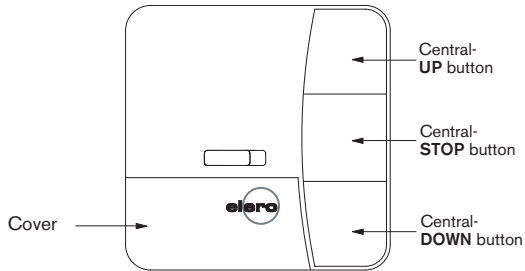

Buttons under the cover

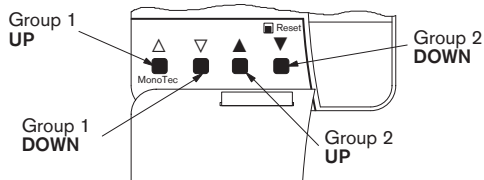

General information

The MonoTec is a central pushbutton switch for the ProLine comfort control unit and can be used to operate two groups centrally or separately.

Note: The MonoTec may be used in combination with ProLine devices only.

The motor **cannot** be operated via the MonoTec directly.

Designated use

The MonoTec may **only** be used to operate roller shutters/venetian blinds in combination with the ProLine comfort control unit.

This device may only be used in connection with equipment from other manufacturers following consultation with your local retailer.

Installation/connection

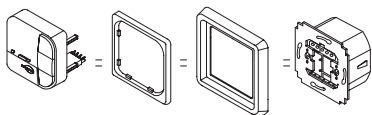

Connection



Warning!



Risk of injury by electric shock!

- This device must be installed by an authorised electrician!

1. Remove the protective caps.
2. Connect.

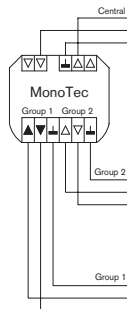

3. Replace the protective caps on the power supply unit.
4. Secure the power supply unit in the box.
5. Insert the operating device into the frame and plug it into the power supply unit.

Installation drawings

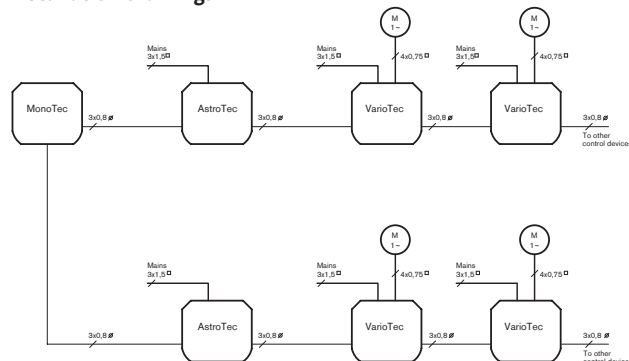

Terminal diagrams

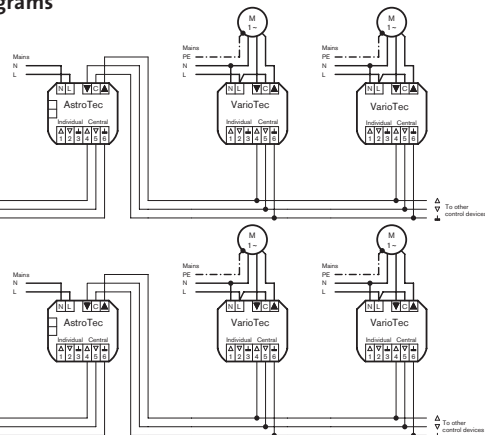

Technical data

Output	2 x group or 1 x central
System of protection	IP 20
The protection class II is guaranteed only after a correct installation.	
Permissible ambient temperature	0 to +55 °C
Type of installation	Concealed: \varnothing 58 mm wall-mounted Exposed: in appropriate exposed casing
Please note:	This device cannot be connected to a motor.

Cleaning

Clean the device with a damp cloth only.

Do not use a cleansing agent as doing so may damage the plastic.

General declaration of conformity:

The company elero GmbH hereby declares that the MonoTec device complies with the basic requirements and other relevant regulations of the EC Directive 1999/5/EG.